

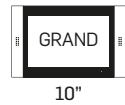

## QUICK INSTALLATION GUIDE INSPINIA TOUCH PANELS

Version INS-QI02-201911  
www.inspinia.eu

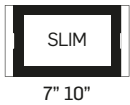

**ASTRUM**  
TECHNOLOGY

## PRODUCT OVERVIEW

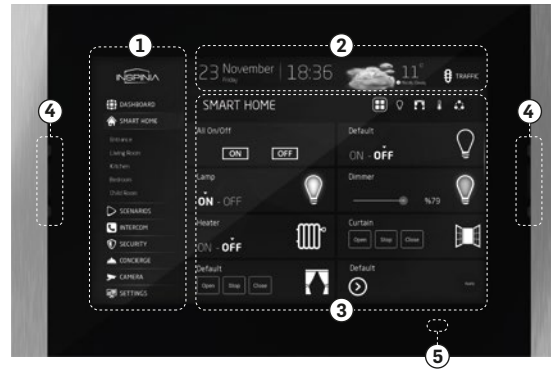

- 1 Menu Bar**
  - Dashboard
  - Smart Home
  - Scenarios
  - Intercom
  - Security
  - Concierge
  - Camera
  - Settings
- 2 Information Bar**
  - Date
  - Time
  - Traffic
  - Weather
- 3 Dashboard**
  - News
  - Messages
  - Shortcuts
  - Dashboard Logo
  - Ambient Temperature
- 4 Speakers**
- 5 Microphone**

## DIMENSIONS

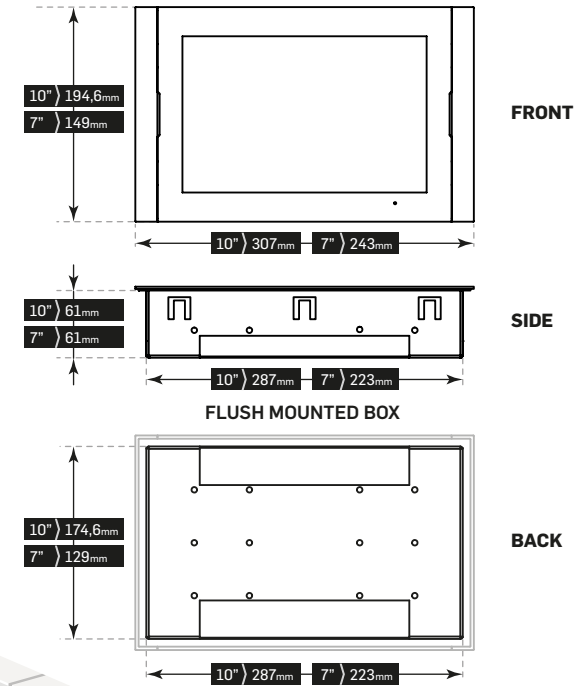

## MOBILE APP

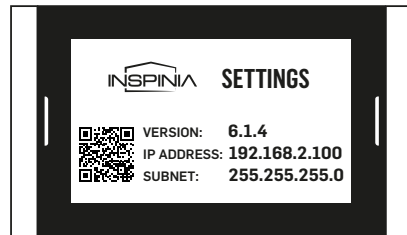

- Download INSPINIA mobile app from App Store or Google Play to your mobile device.
- Make sure that INSPINIA is connected to the network and has internet access.
- Unique device ID and QR-code will be generated on settings page.
- Press add button and scan QR-code on your mobile app.
- Define a name and save your settings. You are ready!

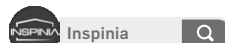
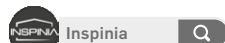

## FEATURES & FUNCTIONALITY

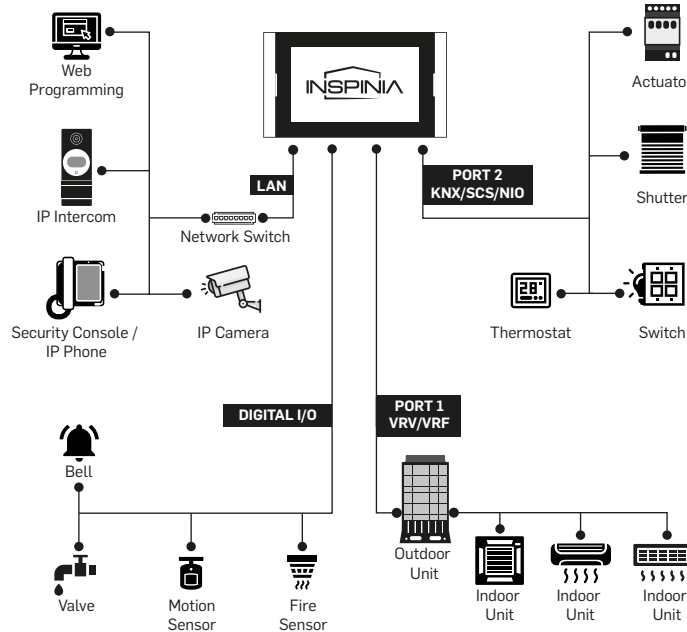

## FLUSH-MOUNTING

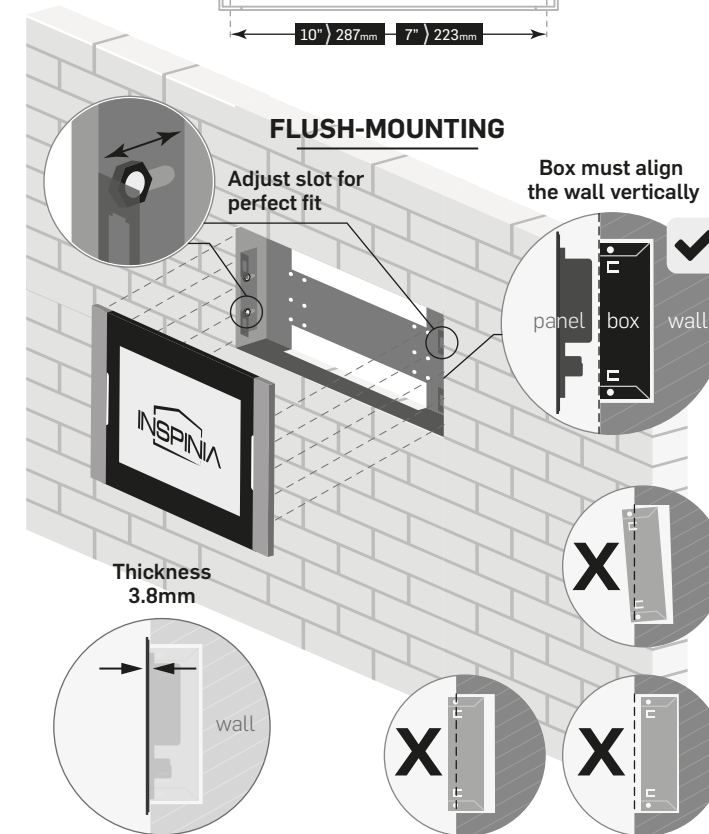

## CONNECTIONS

- Power Supply:** 12V/24V 2A (DC)
- Ethernet:** 10M/100M/1000M (IEEE 802.3)
- Outputs (O1-O2):** Relay 24V, 2A (DC)
- Inputs (I1-I5):** Digital Inputs: bell, motion, gas, flood sensors, magnetic contact
- Port 1 Connector:** VRV/VRF Bus connection & Relay  
**Port 1:** Port for VRV/VRF and Relay add-on modules (VRM, VRR, RLY)
- Port 2:** Port for BMS add-on modules (KNX, SCS, NIO)  
**Port 2 Connector:**

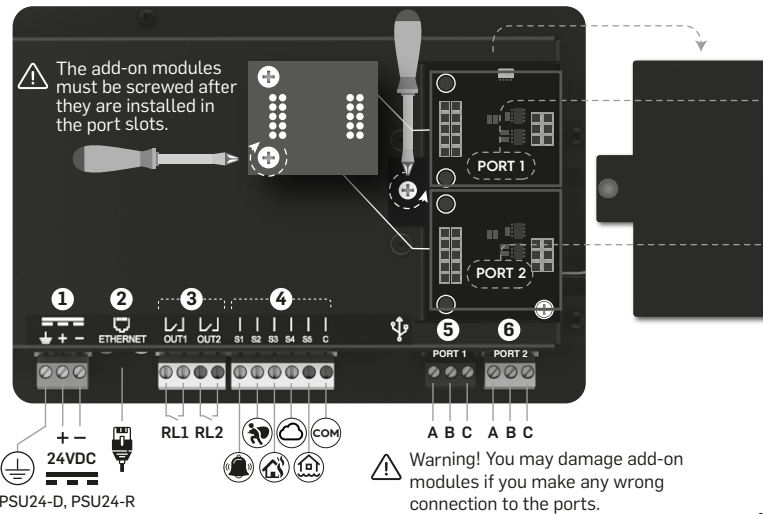
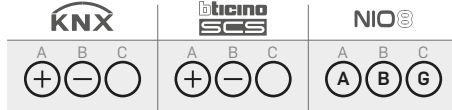

Warning! You may damage add-on modules if you make any wrong connection to the ports.

## OPERATION MODE

Add-on modules can be plugged to extension ports of INSPINIA to provide a various combination of connectivity.

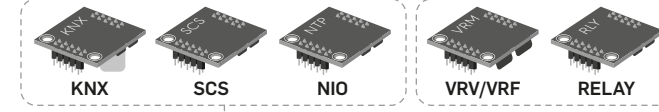

PORT 1	PORT 2	OPERATION MODE
-	-	IP Intercom
-	KNX/SCS/NIO	IP Intercom + Automation
VRV/VRF	KNX/SCS/NIO	IP Intercom + Automation + VRV/VRF
RELAY	-	IP Intercom + Additional Output
RELAY	KNX/SCS/NIO	IP Intercom + Automation + Additional Output

## HVAC Unit Connections

Each brand of HVAC have different communication terminals on outdoor unit. Please check below table for terminals connections.

BRAND	DAIKIN	HITACHI	LG	MITSUBISHI ELECTRIC	MITSUBISHI ELECTRIC	Midea	Panasonic	SAMSUNG	CHIGO	TOSHIBA
<b>Terminal Name</b>	A B C	A B C	A B C	A B C	A B C	A B C	A B C	A B C	A B C	A B C
<b>5 Port 1 connector</b>	F1 F2	1 2	A B	M1 M2	A B	X Y E	U1 U2	F1 F2	X Y E	U1 U2
<b>Comm. Line</b>	D3 NET	TCC LINK	INTER A B	M NET (TB3/7)	S SLINK I / II	64	S3 NET	64	64	TCC LINK
<b>Indoor Unit</b>	64	64	128	50	64	64	64	64	64	64
<b>Outdoor Unit</b>	16	16	NO SUPPORT	10	NO SUPPORT	16	NO SUPPORT	16	16	NO SUPPORT

## CONFIGURATION

- All configurations of touch panel can be made through web interface.

Default IP Address: **192.168.2.100**  
 Port number: **8080**

- Enter IP address and port number to web browser.

Example: **192.168.2.100:8080**   
 Username: **admin** Password: **51G619MH**

- Default Security Password: **1234**
- For more detail please check for [Programming\\_Guide.pdf](#) visit [www.astrum.eu](http://www.astrum.eu)

## HVAC VRV/VRF SOLUTIONS

### 1. MODULE

There are two options of monitoring and controlling VRV/VRF units on INSPINIA:

### 2. VFACE

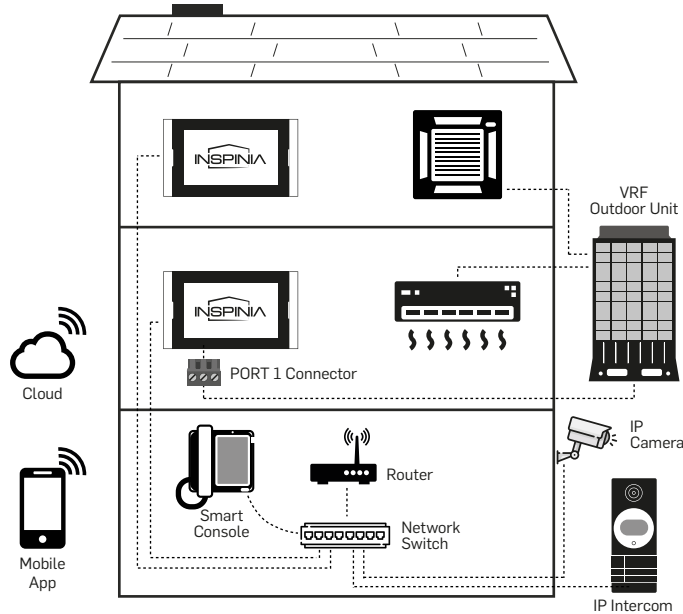

#### 1. MODULE

- VRV/VRF add-on module must be plugged to INSPINIA Port 1
- Port 1 connector will be directly connected to VRV/VRF Outdoor Unit
- Control of Indoor unit available only on one INSPINIA Panel
- Provides full functionality of indoor unit on INSPINIA Panel
- Indoor units can be controlled by KNX and MYHOME Thermostat
- Supports up to 64 indoor units
- Full control on indoor unit functions

#### 2. VFACE

- VFace Basic or VFace Touch is required and need to be installed
- No direct connection to Outdoor Unit with Port 1
- Provides full functionality of indoor unit on INSPINIA Panel
- VFace lets up to 16 simultaneous connection of INSPINIA
- Indoor units can be controlled by KNX and MYHOME Thermostat
- Supports up to 64 indoor units
- Full control on indoor unit functions
- VFace communicates touch panels through IP

